

## VANILLA 3 INCH ADJUSTABLE DOWNLIGHT



Project Name:	Type:
Product Code:	Date:



### Vanilla 3 Inch Adjustable Downlight

The Vanilla product family is a small recessed adjustable downlight providing high visual comfort thanks to a deep recessed LED Engine. Vanilla comes with a modular and tool free LED-engine and optical accessories that are field changeable. Fixture is serviceable through the aperture.

The Body is made of high grade Aluminum. The fixture is tiltable vertically 0-32° and rotatable horizontally 355°. Adjustable 32° always inside ceiling level. The fixtures is provided standard with retrofit housing.

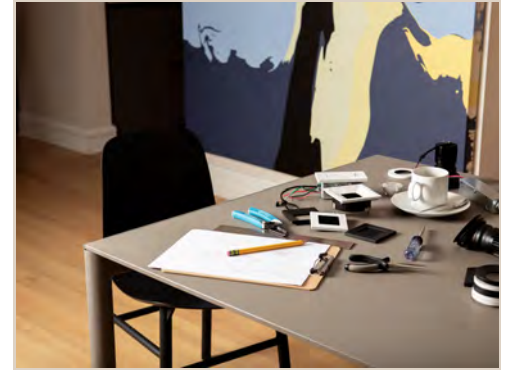

## PERFORMANCE

	STATIC WHITE LED	WARM DIM LED
CCT:	2700K / 3000K	1800K - 3000K
CRI:	97 CRI / 10° 90 CRI	90 CRI
WATTAGE:	9 W(250 mA) / 10° 10 W(700mA)	6 WATTS (350 mA)
LUMENS:	766 Delivered / 10° 1200 Delivered	553 Delivered
SDMC:	2 Step / 10° 2 Step	2 Step
CCT:	2700K 3000K	1800K — 3000K
BEAM SPREAD:	SPOT	NARROW FLOOD FLOOD

## KEY DIMENSIONS

TRIMLESS ROUND	TRIMMED ROUND	MILLWORK ROUND
<p>3.43" (87 mm)</p> <p>Ø±1.4" (Ø±35.5mm)</p> <p>2.43" (61.6 mm)</p> <p>3.94" (100 mm)</p>	<p>3.43" (87 mm)</p> <p>Ø±1.4" (Ø±35.5mm)</p> <p>2.99" (76 mm)</p>	<p>3.43" (87 mm)</p> <p>Ø±1.4" (Ø±35.5mm)</p> <p>2.99" (76 mm)</p>
TRIMLESS SQUARE	TRIMMED SQUARE	
<p>3.43" (87 mm)</p> <p>±1.37" (±34.8mm)</p> <p>2.36" (60 mm)</p> <p>4.53" (115 mm)</p>	<p>3.43" (87 mm)</p> <p>±1.37" (±34.8mm)</p> <p>2.99" (76 mm)</p>	

## HOUSING SPECIFICATIONS

### RETROFIT DRIVE ENCLOSURE SPECS | C-05

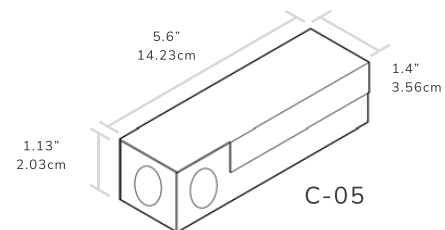

### ELV Standard 2-Wire Dimming

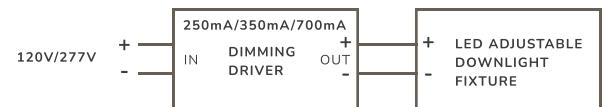

\*FOR OTHER DIMMING STYLES CONTACT LGN

\*\* 250MA DRIVER FOR STATIC WHITE / 350MA DRIVER FOR WARM DIM

## DRIVER SPECIFICATIONS











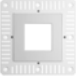
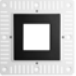

	STATIC WHITE	WARM DIM
DRIVER:	E3 E7	EW
DIMMING PROTOCOL:	ELV 2 Wire	ELV 2 Wire
LED CLASS:	2 Output	2 Output
AC INPUT	110-277VAC 120-50 mA 47-63 HZ	120 V AC 0-11 mA 47-63 HZ
DC OUTPUT:	250mA	700mA
WATTS:	Max 9W	Max 15W

### TRIM OPTIONS

#### R3 - ROUND

TRIM TYPE	TL	TRIMLESS	TR	TRIMMED	FINISH
<b>FX</b> FLAT IP20 (DRY)					 W WHITE
<b>CX</b> CONCAVE IP20 (DRY)					 B BLACK
<b>FH</b> FLAT HEXCELL IP20 (DRY)					 C CUSTOM
<b>FS</b> FLAT SOLITE SHOWER IP44 (WET)					
<b>CS</b> CONCAVE SOLITE SHOWER IP44 (WET)					

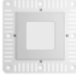
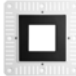
#### S3 - SQUARE

<b>FX</b> FLAT IP20 (DRY)				
<b>CX</b> CONCAVE IP20 (DRY)				
<b>FH</b> FLAT HEXCELL IP20 (DRY)				
<b>FS</b> FLAT SOLITE SHOWER IP44 (WET)				



## ORDER INFORMATION

### Order Code

VAN	PROFILE	TRIM TYPE	FINISH	TEMP	OPTICS	DRIVER	HOUSING	ACCESSORIES							
VAN	RTR3	ROUND TRIMMED	FX	FLAT IP20	W	WHITE	273	2700K	10	E7	ELV**	RT	RETROFIT	X2	2 FIXTURE TRIMLESS MUD KIT
	RTL3	ROUND TRIMLESS	CX	CONCAVE - IP20	B	BLACK	303	3000K	18	E3	ELV		X4	4 FIXTURE TRIMLESS MUD KIT	
	STR3	SQUARE TRIMMED	FH	FLAT HEXCELL -IP20	C	CUSTOM *			24		XX	OTHER***			
	STL3	SQUARE TRIMLESS	FS	FLAT SOLITE SHOWER - IP44					34						
	RML3	ROUND MILLWORK	CS	CONCAVE SOLITE SHOWER -IP44			WD3	(1800 K - 3000K)	17	EW	ELV				
									27						
									35						
									62						

\*CUSTOM FINISHES REQUIRE A MINIMUM QUANTITY OF 25 FIXTURES

\*\*E7 DRIVER FOR 10 DEGREE OPTIC ONLY

\*\*\*OTHER DIMMING OPTIONS AVAILABLE UPON REQUEST

\*\*\*\*CONCAVE SOLITE ONLY AVAILABLE ON ROUND TRIM TYPE

## Fixture Components



## Housing / Retrofit Enclosure Specifications

### E3 (3 Inch) Product Data

#### Specifications:

Dimensions:	5.6" (14.23cm) x 1.4" (3.56cm) x 1.13" (2.03cm)
IP Rating:	IP 20
Light Source:	LED
AC Input:	110-277 VAC - 120-50mA 47-63 Hz

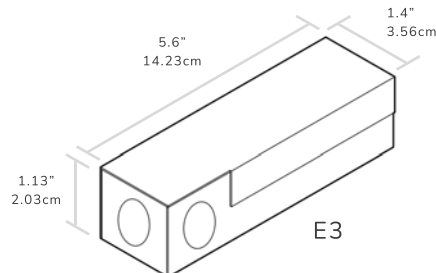

## INSTALLATION GUIDE

### Trimless

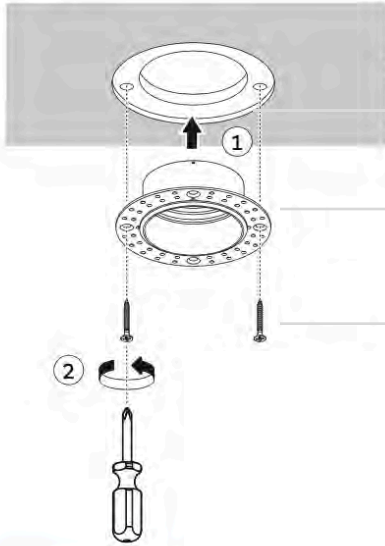

**Ceiling Cutout:**  
2.76 inches/70 mm

**Hole Saw**  
Required for installation for ceiling cutout

**Screws**  
Plaster rig is installed at ceiling cutout using screws

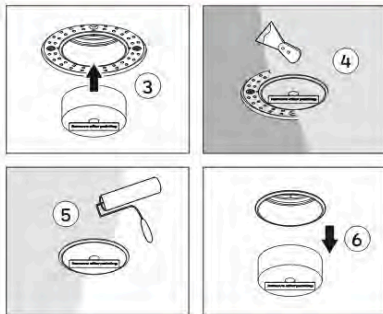
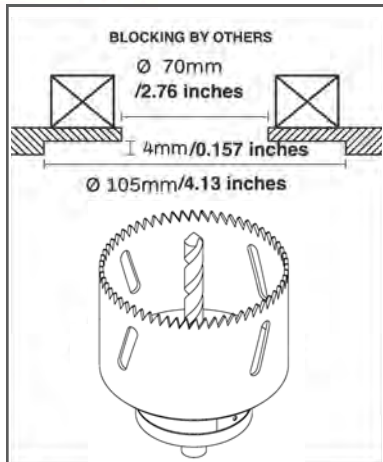

**Cover Trim for paint**  
Before plastering and painting, cover the trip

**Remove Cover**  
Once finished painting and plastering remove cover.

### Trimmed

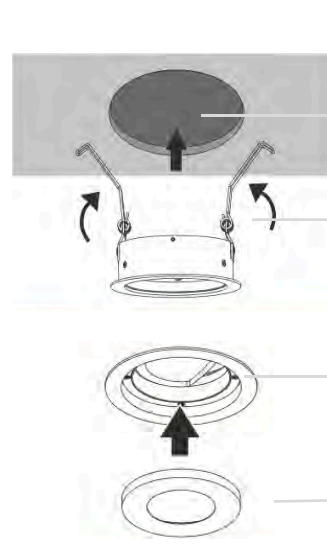

**Ceiling Cutout:**  
2.76 inches/70 mm

**Butterfly Clips**  
Hold trimless fixtures in place

**Gimbal Magnets**  
The gimbal snaps into place via magnets within the trim

**Trim Magnets**  
The trim type also snaps into place using magnets for stress free installations

### Millwork

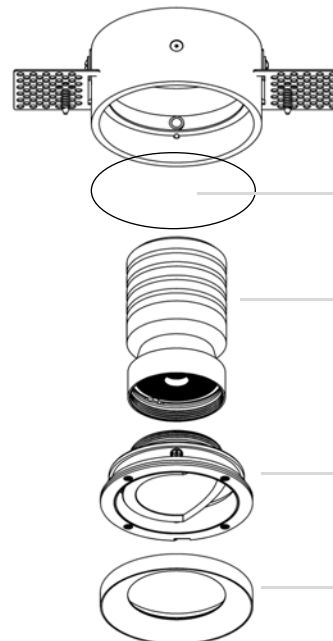

**Millwork Mount:**  
Installed from the back, with two set screws, height adjustable

**Millwork Cutout:**  
2.59 inches/66 mm  
see dimensions above for fixture measurements

**LED Module**  
Attached to the adjustable ring will snap into the Millwork mount

**Adjustable Ring**  
Snaps into the Millwork mount

**Trim Magnets**  
The trim type also snaps into place using magnets for stress free installations