

VANILLA 4 INCH ADJUSTABLE DOWNLIGHT

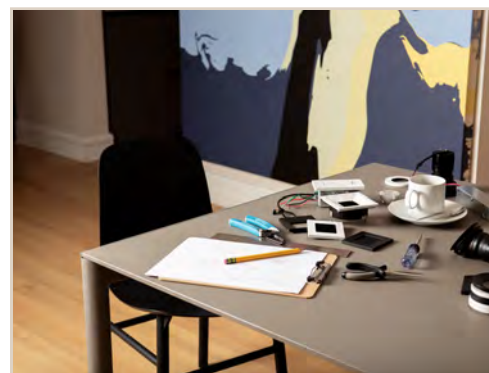

Vanilla 4 Inch Adjustable Downlight

The Vanilla product family is a small recessed adjustable downlight providing high visual comfort thanks to a deep recessed LED Engine. Vanilla comes with a modular and tool free LED-engine and optical accessories that are field changeable. Fixture is serviceable through the aperture. The Body is made of high grade Aluminum. The fixture is tiltable vertically 0-35° and rotatable horizontally 355°. Adjustable 35° always inside ceiling level. The fixtures is provided standard with retrofit housing. IC (title 24) housing available as an option for 4 inch version of fixture.



PERFORMANCE

	STATIC WHITE LED	WARM DIM LED
CCT:	2700K / 3000K	1800K - 3000K
CRI:	97 CRI	90 CRI
WATTAGE:	12 WATTS (350 mA)	10 WATTS (350 mA)
LUMENS:	1060 Delivered	998 Delivered
SDMC:	2 Step	2 Step
CCT:	2700K 3000K	1800K 3000K
BEAM SPREAD	SPOT	NARROW FLOOD
		FLOOD

KEY DIMENSIONS

TRIMLESS ROUND	TRIMMED ROUND	MILLWORK ROUND
TRIMLESS SQUARE	TRIMMED SQUARE	MILLWORK SQUARE

DRIVER SPECIFICATIONS

	STATIC WHITE (E4)	WARM DIM (EW)
DIMMING:	ELV 2 Wire	ELV 2 Wire
LED CLASS:	2 Output	2 Output
AC INPUT	110-277 VAC 0.23 - 0.09A 50/60 HZ	110 - 277 VAC 0.23-0.09A 50/60 Hz
DC OUTPUT:	350mA	350mA
WATTS:	Max 18W	Max 18W

HOUSING SPECIFICATIONS

RETROFIT DRIVE ENCLOSURE SPECS | C-06

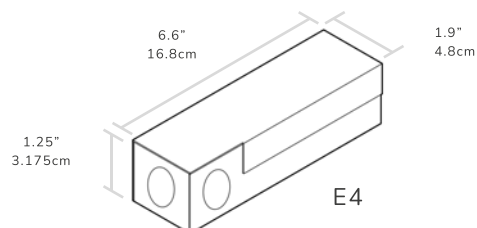

ELV Standard 2-Wire Dimming

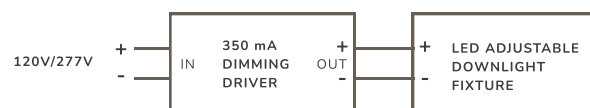







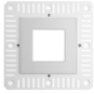

*FOR OTHER DIMMING STYLES CONTACT LGN

TRIM OPTIONS

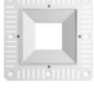
R4 - ROUND

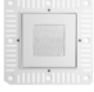
TRIM TYPE	TL TRIMLESS	TR TRIMMED	FINISH
FX FLAT IP20 (DRY)			 W WHITE
CX CONCAVE IP20 (DRY)			 B BLACK
FH FLAT HEXCELL IP20 (DRY)			 C CUSTOM
FS FLAT SOLITE IP44 (WET)			

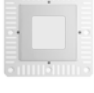
S4 - SQUARE

FX FLAT IP20 (DRY)		
CX CONCAVE IP20 (DRY)		
FH FLAT HEXCELL IP20 (DRY)		
FS FLAT SOLITE IP44 (WET)		



LIGHT CREATING SPACE



VANILLA 4 INCH ADJUSTABLE DOWNLIGHT

ORDER INFORMATION

Order Code

VAN	PROFILE	TRIM TYPE	FINISH	TEMP	OPTICS	DRIVER	HOUSING
VAN	RTR4 ROUND TRIMMED	FX FLAT IP20	W WHITE	274 2700K	11	E4 ELV	RT RETROFIT
	RTL4 ROUND TRIMLESS	CX CONCAVE - IP20	B BLACK	304 3000K	23	XX OTHER**	IC IC (TITLE 24)
	STR4 SQUARE TRIMMED	FH FLAT HEXCELL -IP20	C CUSTOM *	WD4 (1800 K - 3000K)	34	EW ELV**	
	STL4 SQUARE TRIMLESS	FS FLAT SOLITE SHOWER - IP44			20		
	RML4 ROUND MILLWORK	CS CONCAVE SOLITE SHOWER -IP44			30		
	SML4 SQUARE MILLWORK				38		
					60		

*CUSTOM FINISHES REQUIRE A MINIMUM QUANTITY OF 25 FIXTURES

**OTHER DIMMING OPTIONS AVAILABLE UPON REQUEST

*** IC HOUSING REQUIRED FOR JAB T24 COMPLIANCE

****CONCAVE SOLITE ONLY AVAILABLE ON ROUND TRIM TYPE

***** ONLY CONCAVE SQUARE MILLWORK TRIM IS AVAILABLE

Fixture Components

Housing/Enclosure		Power Source 120 V Connection	Housing Enclosure Options RT - Retrofit Retrofit housing for all other
Driver		Housing/ Enclosure Above ceiling IC housing or Above ceiling RT Retrofit Housing enclosure for ELV driver and line voltage connection	
Light Source		Driver Low Voltage ELV Standard 2 Wire Dimming. Other Dimming Styles available through custom orders. Contact LGN.	IC - Insulated Ceilings IC Housing required for Insulated ceilings. Required JAB T24 Compliance
Optics		Light Source LED engine with 3 CCT options. Adjustable gimbal trim allows for aimable spot lighting.	
		Optics Field-interchangeable optic reflectors with spot, narrow flood, and wide flood beam spread options.	

Housing / Retrofit Enclosure Specifications

E4 (4 Inch) Product Data

RT - Retrofit

Specifications:

Dimensions:	6.6" (16.8cm) x 1.9" (4.8cm) x 1.25" (3.175cm)
IP Rating:	IP 20
Light Source:	LED
AC Input:	110-277 VAC - 0.23-0.09A 50/60 Hz

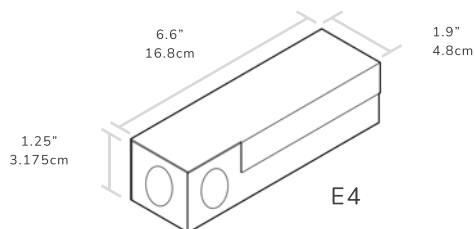

IC - Insulated Ceiling Housing Enclosure (IC TITLE 24)

Specifications:

Dimensions:	8 1/2" x 11 13/16" x 6 7/8"
IP Rating:	IP 20
Light Source:	LED
AC Input:	110-277 VAC - 0.23-0.09A 50/60 Hz

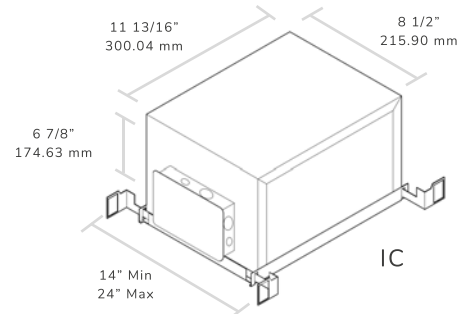

INSTALLATION GUIDE

Trimless

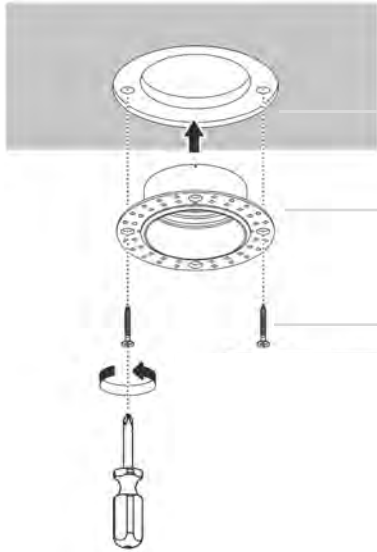

Ceiling Cutout:
3.6 inches/92 mm

Hole Saw
Required for installation for ceiling cutout

Screws
Plaster rig is installed at ceiling cutout using screws

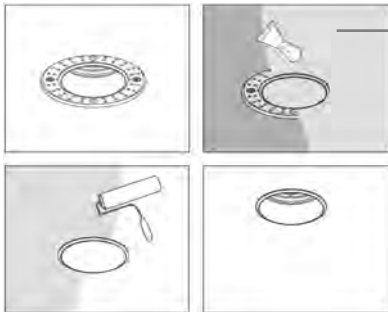
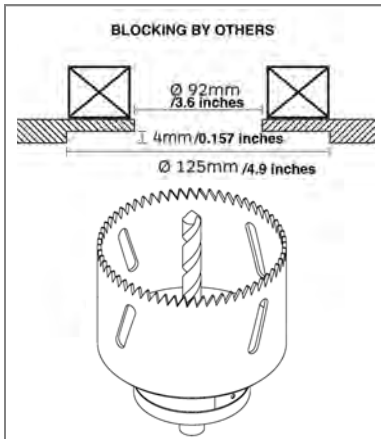
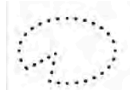

Cover Trim for paint
Before plastering and painting, cover the trim

Remove Cover
Once finished painting and plastering remove cover.

Trimmed

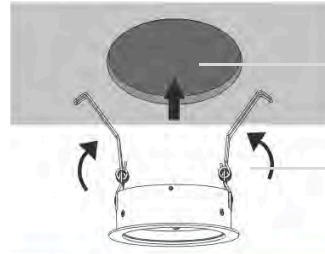

Ceiling Cutout:
3.6 inches/92 mm

Butterfly Clips
Hold trimless fixtures in place

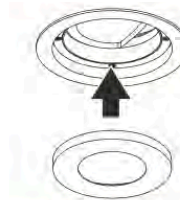

Gimbal Magnets
The gimbal snaps into place via magnets within the trim

Trim Magnets
The trim type also snaps into place using magnets for stress-free installations

Millwork

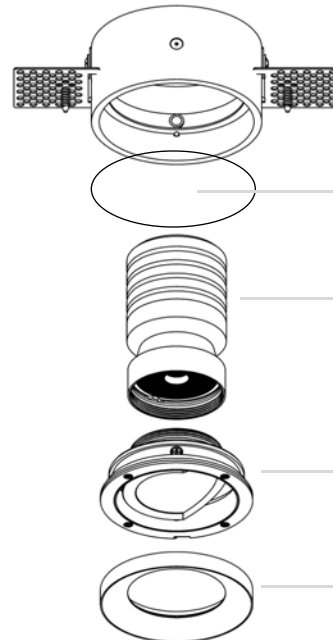

Millwork Mount:
Installed from the back, with two set screws, height adjustable

Millwork Cutout:
Round: 3.46" (88mm)
Square: 3.46"x3.46" (88x88mm)
see dimensions above for fixture measurements

LED Module
Attached to the adjustable ring will snap into the Millwork mount

Adjustable Ring
Snaps into the Millwork mount

Trim Magnets
The trim type also snaps into place using magnets for stress-free installations