

| | |
|---------------|-------|
| Project Name: | Type: |
| Product Code: | Date: |

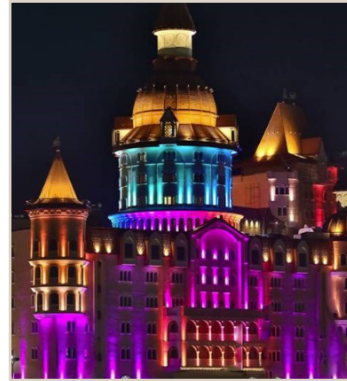

SPOT 7

The Vanilla Spot 7 is an alternative multi-chip LED configuration with distinctive aesthetics, using quad-color LEDs for superior color mixing directly at the lens. The efficient combination of powerful RGB+W (3000K or 4000K) multi-chip LEDs and unparalleled optical lenses, deliver seamless light distribution and smooth color transitioning. Featuring a lightweight and compact body, printed front glass and no visible screws, the Vanilla Spot 7 offers a variety of finish options. Along with this a variety of accessories are available to further increase the versatility of the product. (IP67)



PERFORMANCE

| | LED |
|-----------------|--------------------------|
| CCT: | RGBW3000K / RGBW4000K |
| LUMENS: | 1646 Lm |
| WATTAGE: | 38 WATTS |
| POWER (A/V): | 0.18A@230V / 38W MAX |
| POWER: | 120-277V |
| IP RATING: | IP67 |
| IK RATING: | IK07 |
| LED LIFE: | 50,000 hours |
| OPERATING TEMP: | -40°C-50°C (-40°F-122°F) |
| SDCM: | 2 STEP |
| CCT: | 3000K 4000K |



OPTICS / BEAM SPREAD: 9° 13° 23° 50°

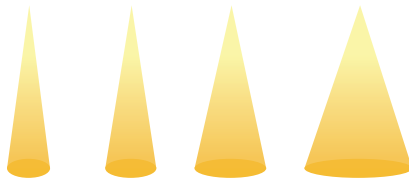

KEY DIMENSIONS

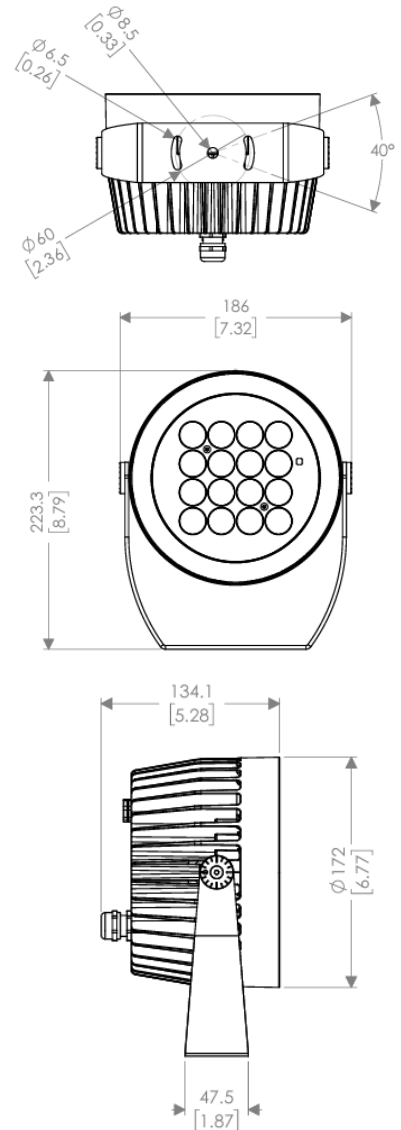

ORDER INFORMATION

| Order Code | | | | | | | | | |
|------------|---------|------------|--------|-----|----------|------------|---------|----------------------------------|-------------------|
| MAKE | PROFILE | COLOR TEMP | OPTICS | | FINISHES | | DIMMING | CONNECTION TYPE | ACCESSORIES |
| VAN | SP5345 | RGBW3 | SP | 9° | BK | Black | DMX | Power In, DMX In, DMX Out | POLAR |
| | | RGBW4 | NA | 13° | AN | Anthracite | | Hybrid Cables with Connectors | ANTI-SALINE |
| | | | ME | 23° | GR | Grey | | Hybrid Cables without Connectors | 3G FIXING BRACKET |
| | | | WI | 50° | WH | White | | | SNOOT |
| | | | | | | | | | VISOR |
| | | | | | | | | REMOTE | |

WIRING DIAGRAM

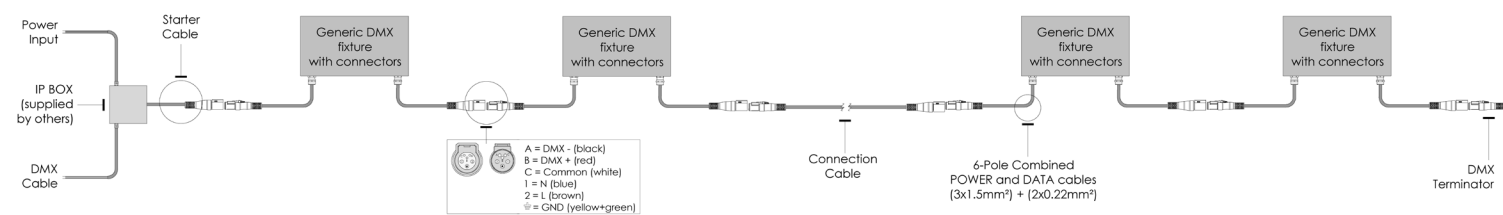

- IP BOX - Max 10A (ampere) per daisy chain;
- Max 32 fixture per daisy chain;
- The total DMX LINE lenght must not exceed 1000 ft;